

## INSTALLATION WARNINGS:

### BEFORE COMMENCING INSTALLATION ISOLATE YOUR MAINS ELECTRIC SUPPLY

Read the instructions carefully before starting the installation process and keep them for future reference. This product must be installed by a qualified electrician. This product should be installed in accordance with the relevant sections of the building regulations code, and the current edition of the IEE Wiring Regulations (BS 7671: Requirements for electrical installations) and appropriate statutory regulations.

Do not exceed the Maximum Power Rating detailed in the specification over leaf.

## Installation

**Remove the glass panel** of a touch remote switch: Using a small flat screwdriver remove the front cover by placing the screw driver in the location notch on the bottom part of the cover and twist to unclip the cover.

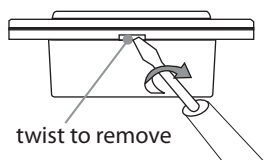

**Wiring:** Wire as described in the diagram opposite. Push wires firmly into terminals and tighten terminal screws so that wires are held securely. No bare wires should protrude from the terminals. Ensure correct wires are connected to the correct terminals, if incorrectly wired, this could damage the switch.

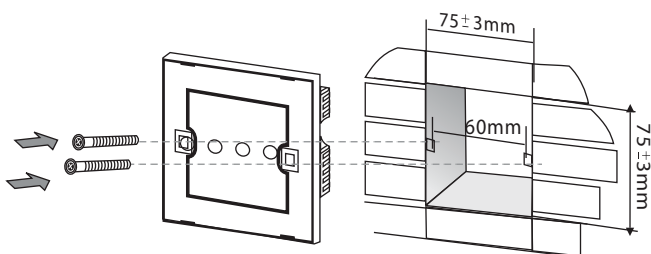

**Fix screws:** Use the screws supplied to attach switch to backbox using a flat head screwdriver

**Reattach the glass panel:** Align the glass panel over the switch and firmly push to click into place.

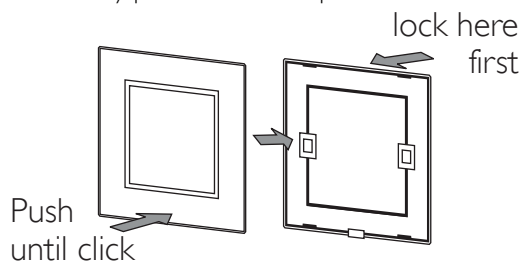

**Power on:** Once the power is on, wait 2 minutes for the switch to power up, then touch the panel to turn on the light.

## The remote (RTS2030 remote models only)

### Pairing a remote

1. Touch & hold the dim down touch area of the switch for 5 seconds and wait for the beep.

2. Press and hold a button A (for 1 gang) or B (for 2 gang) on the remote control and release after you hear a beep.

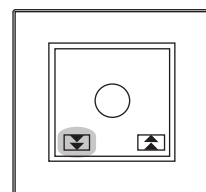

### Un-registering a remote:

Repeat steps for registering the remote. When pressing and holding the remote button, wait for two beeps and the remote will be un-paired.

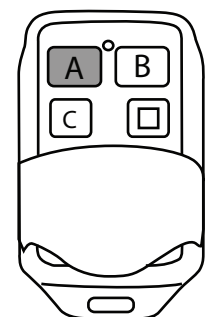

**Factory reset:** Press and hold the switch for 5 seconds till you hear a beep, continue to hold for a further 8 seconds until you hear another beep. The switch is now back to factory settings.

**Optional scene remote** available, Can control up to 19 gangs and set up to 4 scenes.

### Using the dimmer

#### TO TURN ON

Tap once around the circle to turn on. Double tap to go to max brightness

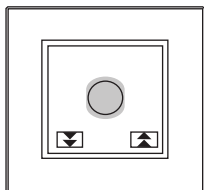

#### TO TURN OFF

Touch the switch panel the circle to turn off

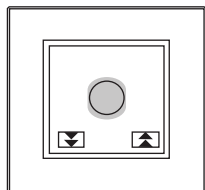

#### DIM UP & DOWN

Touch & hold the down arrow to dim down and the up arrow to dim up.

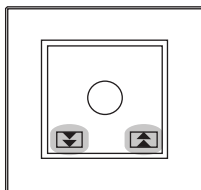

#### USING THE REMOTE

Press A (for one gang) B (for two gang), light turns on, press again to turn the light off. press C or  to dim up and down.

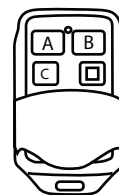

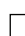
A = 1 gang  
B = 2 gang  
C = Dim up  
 = Dim down

### Wiring diagrams

#### 1 Gang model

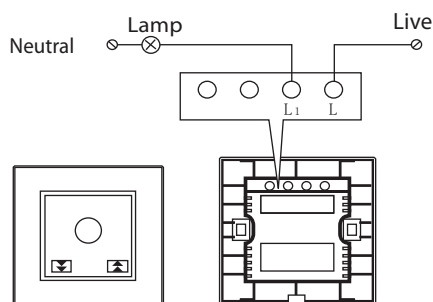

#### 2 Gang model

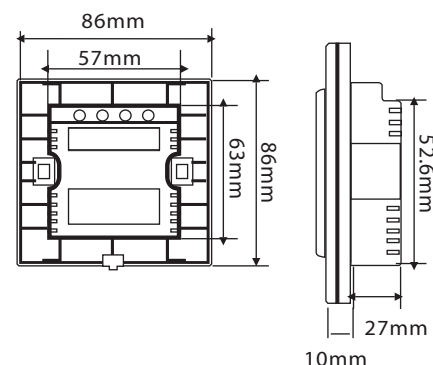
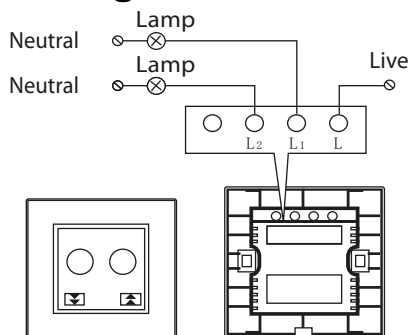

### Specification

Voltage: 220~240V ~ 50/60Hz

Operating Power:

1 Gang (1-300W),  
2 Gang (1-600W),

Working Temperature: 0oC~40oC

Relative Humidity: 10% - 93%

Energy Consumption: <0.02W

Measurement: 86x86mm  
Backbox depth: 35mm

life: 100,000 times at least (relay useful life)

Remote usage distance >20M

Remote battery: 27A 12vDC

Battery life : 1 year (dependent on usage)

Power: < 0.1mW

CE & RoHS Certified

### Features

- Microline Glass Panel
- Touch & Remote control
- Memory dimming feature (Remembers last lighting setting)
- Auto gradual dim up/down on power on/off.
- Remote control upto 20m (RF 433Hz)
- Background light (with indicator light)
- Chrome surround
- Trailing Edge Dimmer
- Works with LED's, Halogens, standard bulbs.

### Guarantee

All items purchased, come with a 1 year warranty (from date of purchase). Please keep proof of purchase.

If any of our products become faulty within this 1 year period, please contact us. Please send product/s by recorded post, as proof of dispatch as we cannot be held liable for products lost in the post. If the product is found to be faulty, a replacement shall be sent within 7 working days from date received. In all cases, an identical replacement shall be sent, however, if the product has been discontinued a suitable alternative shall be sent with the same or similar specification.

